

# thermohouse

the low energy building system



+353 (0) 64 6631307  
[www.thermohouse.ie](http://www.thermohouse.ie)

Manufactured & produced in Ireland



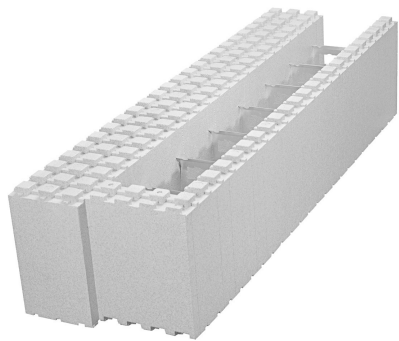

**ThermoWall**



**ThermoFloor**

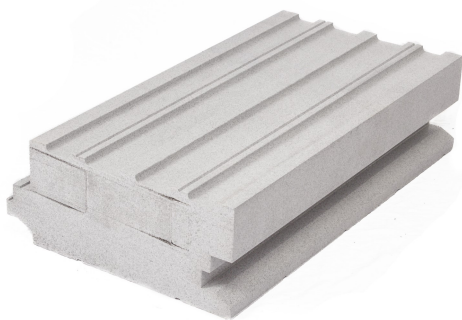

**ThermoRoof**

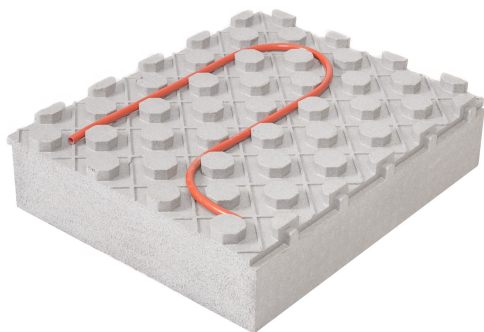

**ThermoBoard**



the low energy building system



Rapid  
Build



Exceeds  
nZEB



60 Year  
Guarantee

At Thermohouse, we model, manufacture, supply and build a complete energy efficient building system. Delivering high performance, future-proof homes across Ireland and the UK.

View our Thermohouse module explainer videos here:







Self Build — Kent

Our walls, floor and roof components can be used individually, or combined to form an **airtight thermal envelope**.

The full system forms a monolithic **concrete structure, fully wrapped in insulation**, which is extremely airtight and free from any cold bridging.

These eco buildings can be **designed and finished to any desired aesthetic**. Curved or rectangular, timber cladding or brick – Whatever you imagine your dream home to be, with Thermohouse it is achievable.

## What is the Thermohouse System?

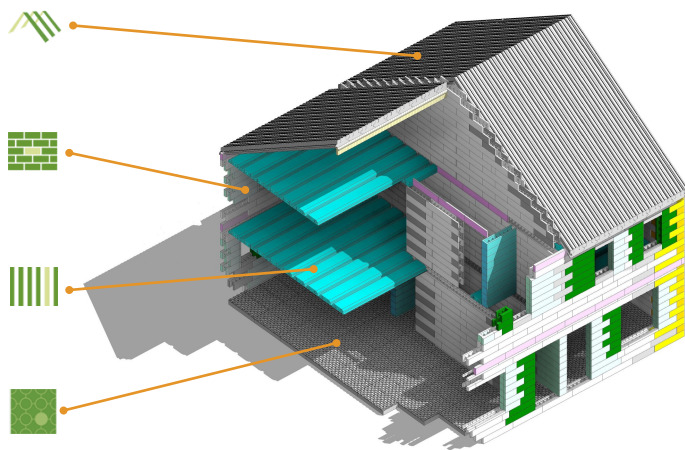

thermowall



thermofloor



thermorooft



thermoboard

Innovative All-in-one Building System – Walls, floors & roof

Rapid Build – Up to 60% faster than traditional methods

Strong and safe home – 60-year system warranty

Energy Efficiency – Significantly lower energy bills

## Why Thermohouse?



Energy Efficiency



Comfort & Warmth



Sound Insulation



Speed of Build



Airtightness



Superior Structures



Design Flexibility



Easy to Transport & Assemble

## Where does the production take place?

The entire Thermohouse building system is produced in our state of the art manufacturing facility in Killarney, Ireland, V93 XK82.

Thermohouse manufacture each element of our building system to ensure a high-quality standard is guaranteed. This ensures that we have full traceability on our products. Each element is rigorously tested and endorsed by the relevant certifying bodies.



Self Build — Co. Dublin



Self Build — Co. Cork

# How can Thermohouse System help you with nZeb regulations?

NZEB or 'Nearly Zero Energy Buildings', is a building standard which applies to all new buildings occupied after the **31st December 2020**.

NZEB means a building that has a very high energy performance where the nearly zero or very low amount of energy required should be covered to a very significant extent by energy from renewable sources including energy from renewable sources produced on-site or nearby, as per Part L 2019.

### The Thermohouse solution:

At Thermohouse, we manufacture, supply and install a building solution which is both **nZEB and Part L 2019 compliant**. The Thermohouse nZEB solution is a complete energy efficient building envelope, featuring superior airtightness, high levels of insulation and minimal thermal bridging. In addition, our nZEB houses, use far less energy than traditional builds, increasing comfort and lowering energy bills!

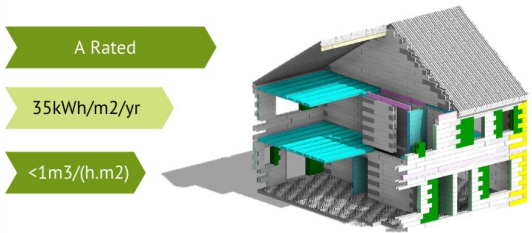

Thermohouse have an in house technical and design office with industry professionals such as Structural Engineers, CAD Technicians and Estimators to assist with your project.

## The U-values achieved by the Thermohouse system

Component	Part L Requirement	Thermohouse Range
Walls	0.18 W/m2K	0.15 – 0.10 W/m2K
Ground Floor	0.18 W/m2K	0.18 – 0.12 W/m2K
Roof	0.16 W/m2K	0.15 W/m2K
Airtightness	<5 m3/hr/m2	<1 m3/hr/m2

Independent certification is supplied for all Thermohouse products



**CONTACT  
US  
TODAY!**

**Request a call back & free quote: +353 (0) 64 663 1307**

If you've got any questions about our low energy building system, we would be delighted to hear from you. We will offer a no obligation consultation and prepare a quotation for you free of charge. One of our friendly team will be in touch with you soon to see how we may support & guide you with your project.

**[WWW.THERMOHOUSE.IE](http://WWW.THERMOHOUSE.IE)**

